

Begane Grond

3.29 m 2.40 m

4.06 m
3.30 m

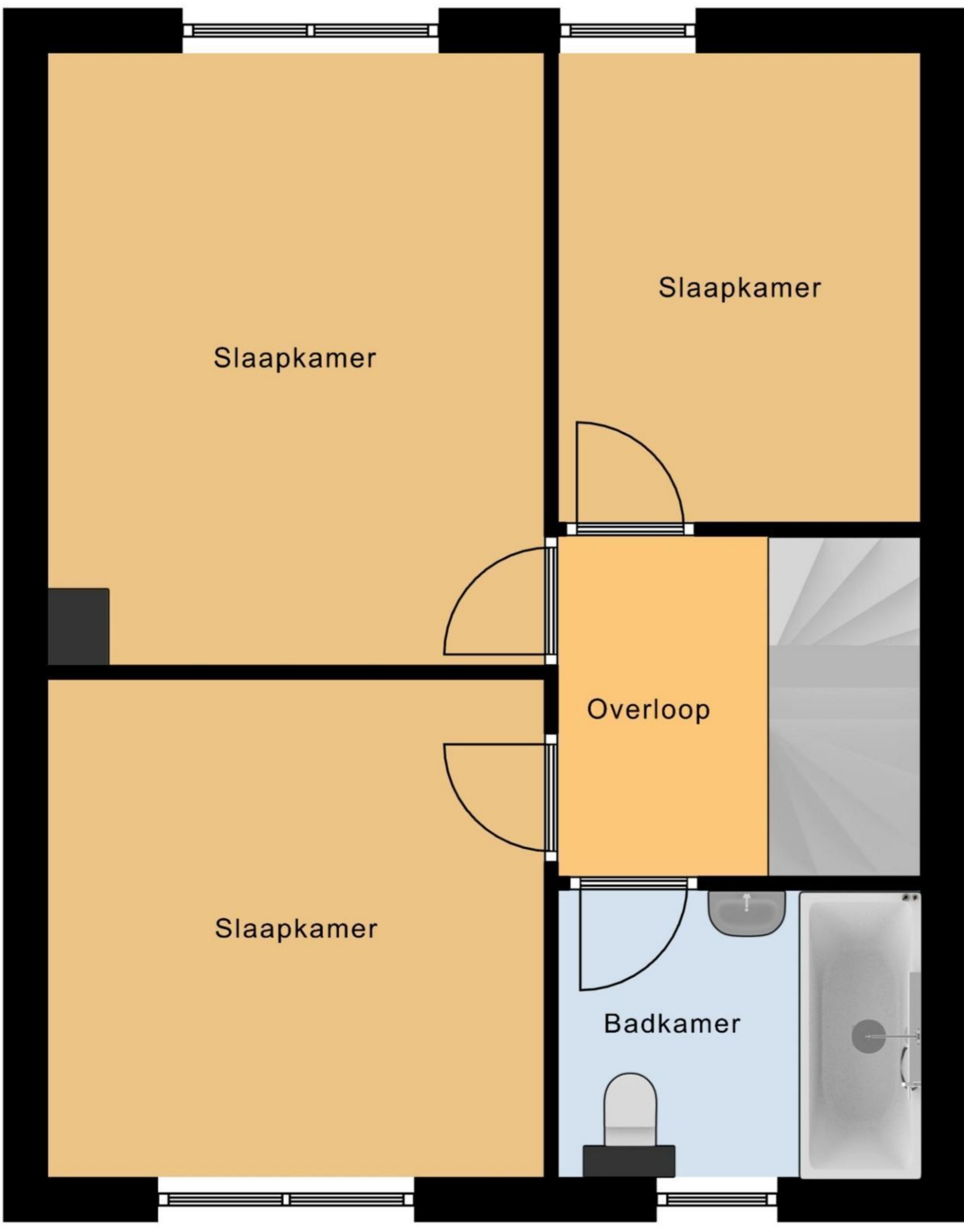

3.11 m
2.25 m
1.90 m
7.46 m

5.79 m

Eerste Verdieping

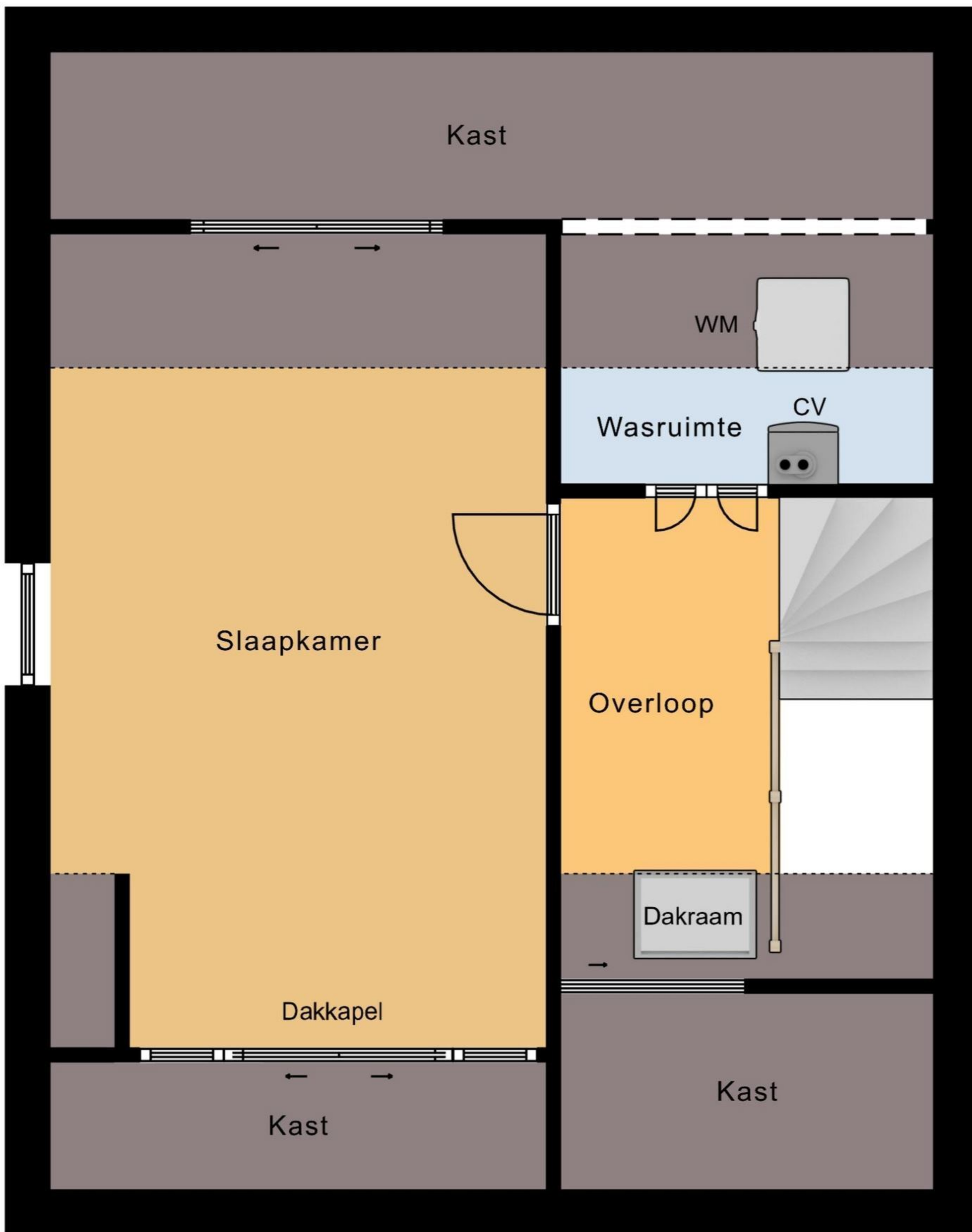

5.34 m

1.63 m

3.05 m

3.24 m

2.44 m

Tweede Verdieping

← 2.01 m →

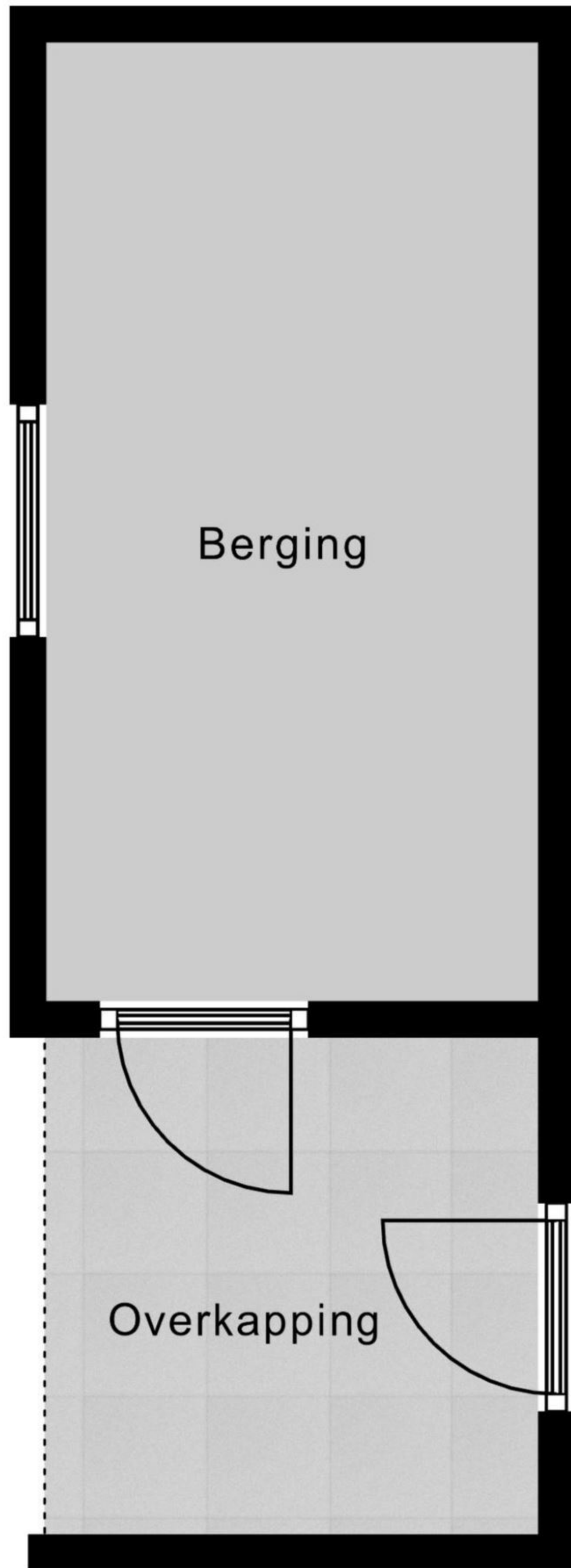

3.92 m

2.03 m

← 2.02 m →

Berging