



Begane Grond



1e Verdieping

← 1.64 m →

← 0.80 m → ← 4.40 m →

↑ 2.86 m ↓
↑ 4.62 m ↓
↑ 7.62 m ↓

↑ 3.75 m ↓
↑ 3.67 m ↓

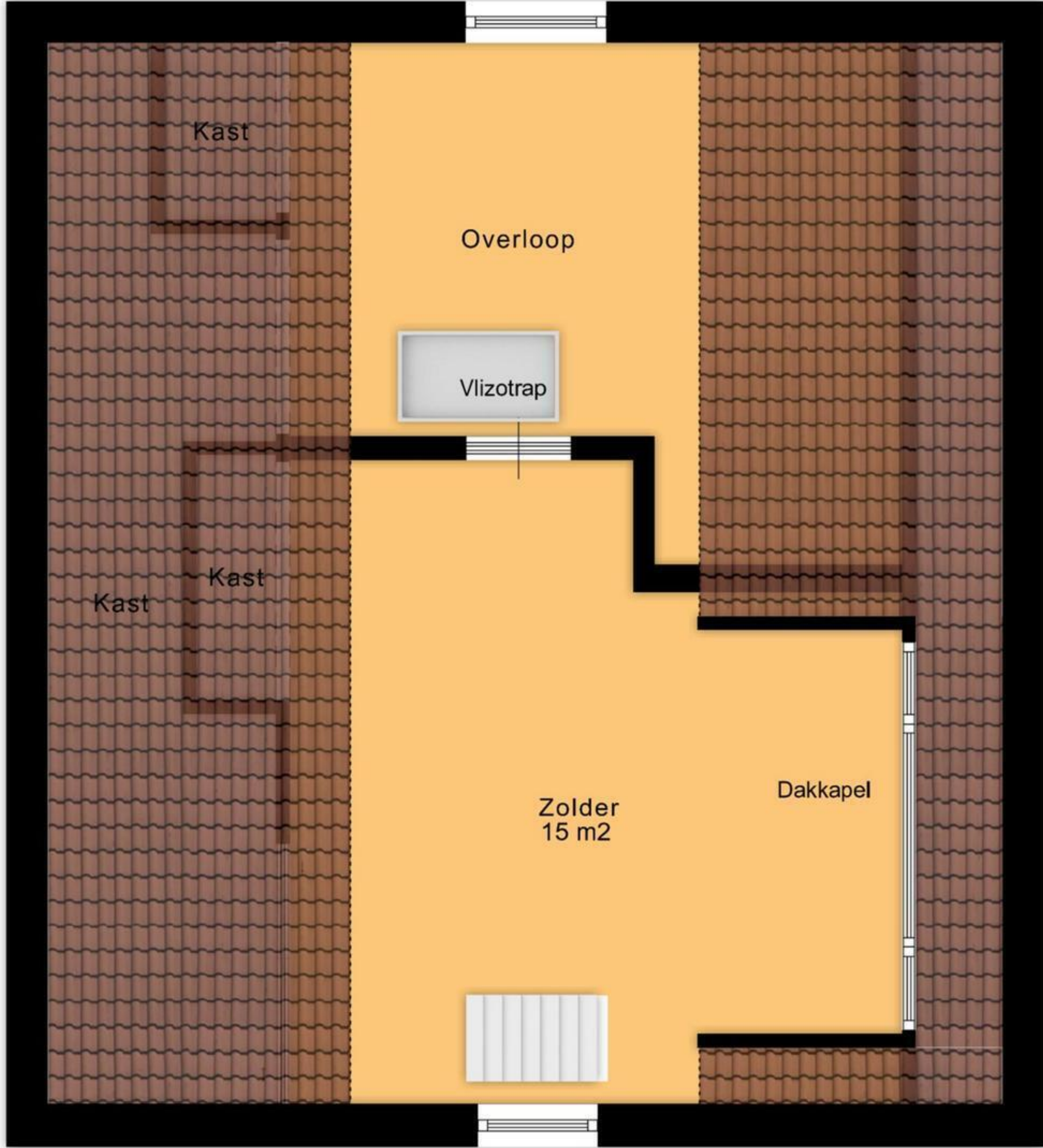

← 4.40 m →

← 2.51 m →

Zolder