

Begane Grond

← 1.13 m → ← 1.00 m →

← 3.14 m → ← 2.18 m →



1e Verdieping

4.32 m

1.06 m
4.17 m
2.01 m

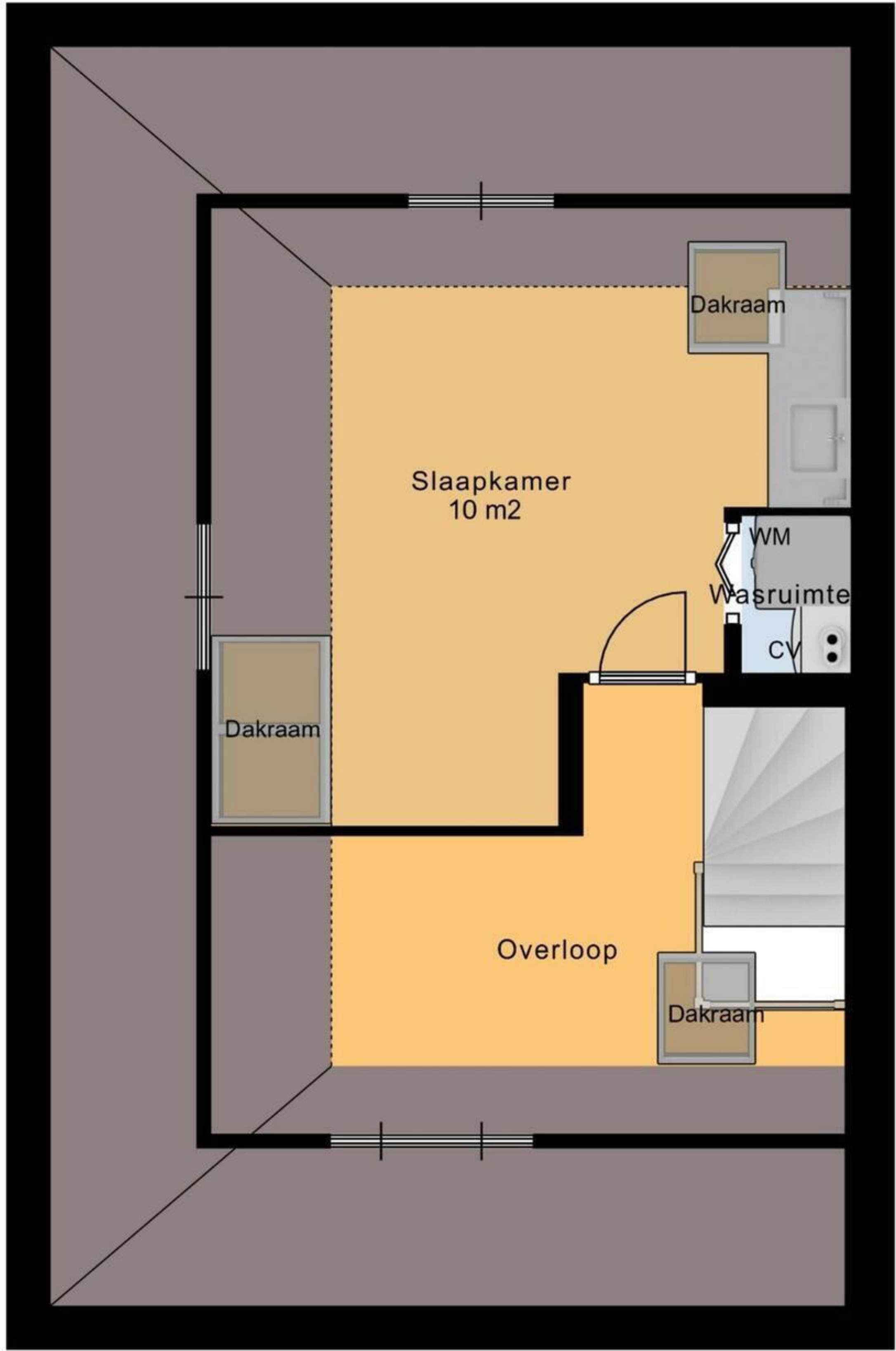

3.14 m
5.27 m
3.04 m

3.51 m

4.28 m

2e Verdieping

2.49 m

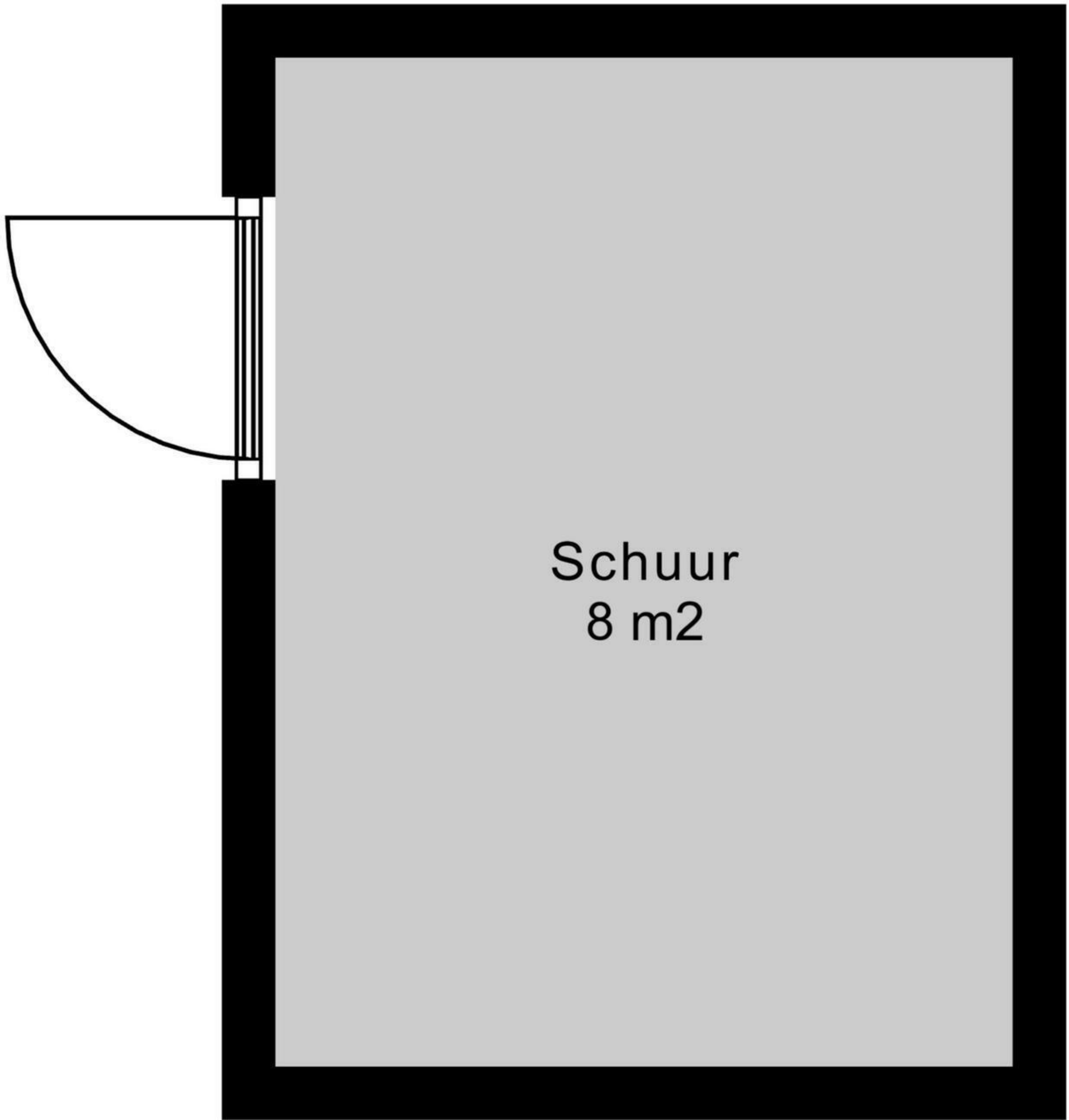

3.40 m

Schuur