

Begane Grond

4.90 m

4.32 m  
4.76 m  
2.80 m  
3.20 m

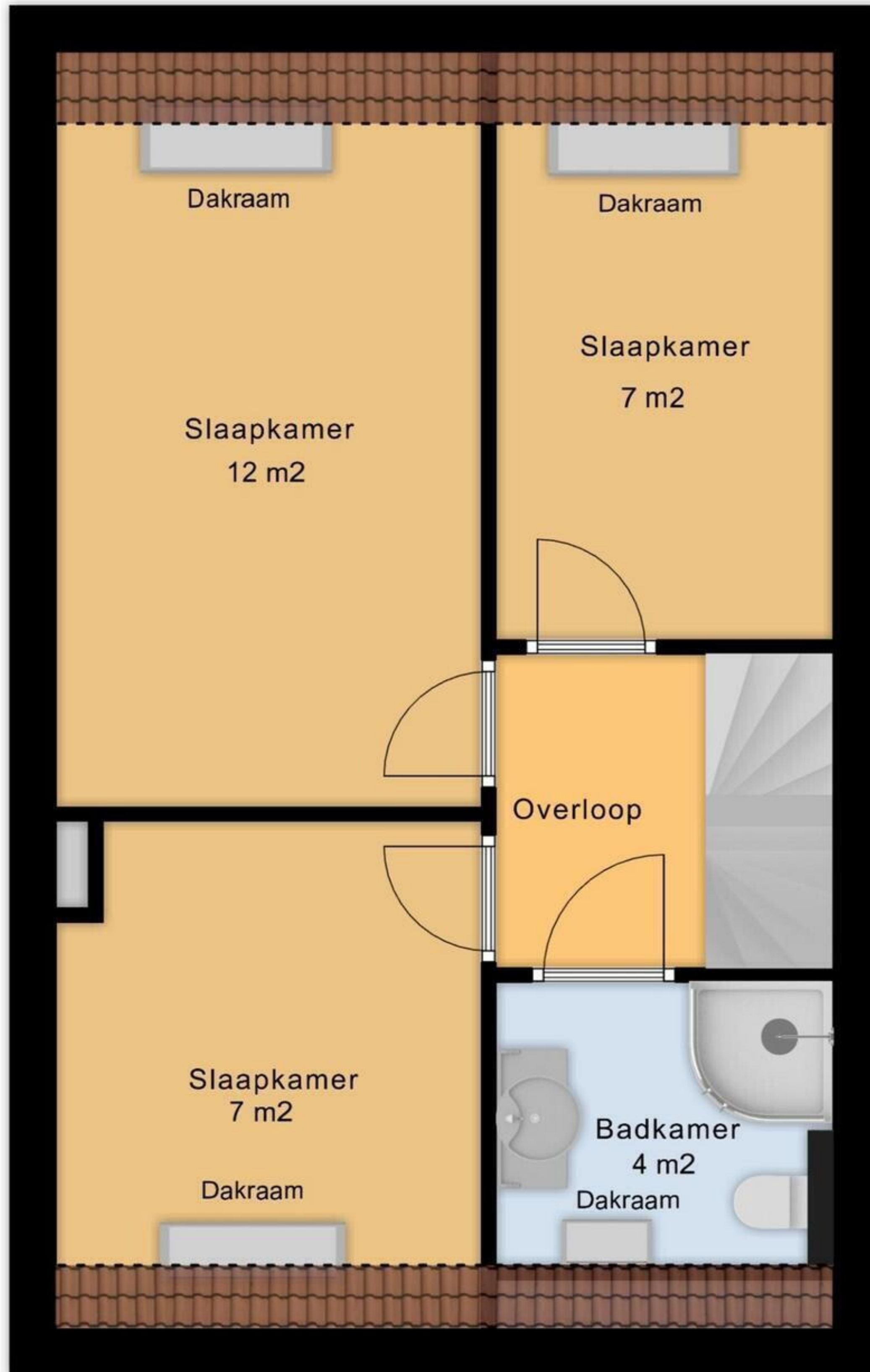

3.71 m  
3.26 m  
1.97 m  
1.78 m

2.68 m 2.12 m

### Eerste Verdieping



3.86 m 0.94 m

3.19 m  
4.41 m  
1.42 m

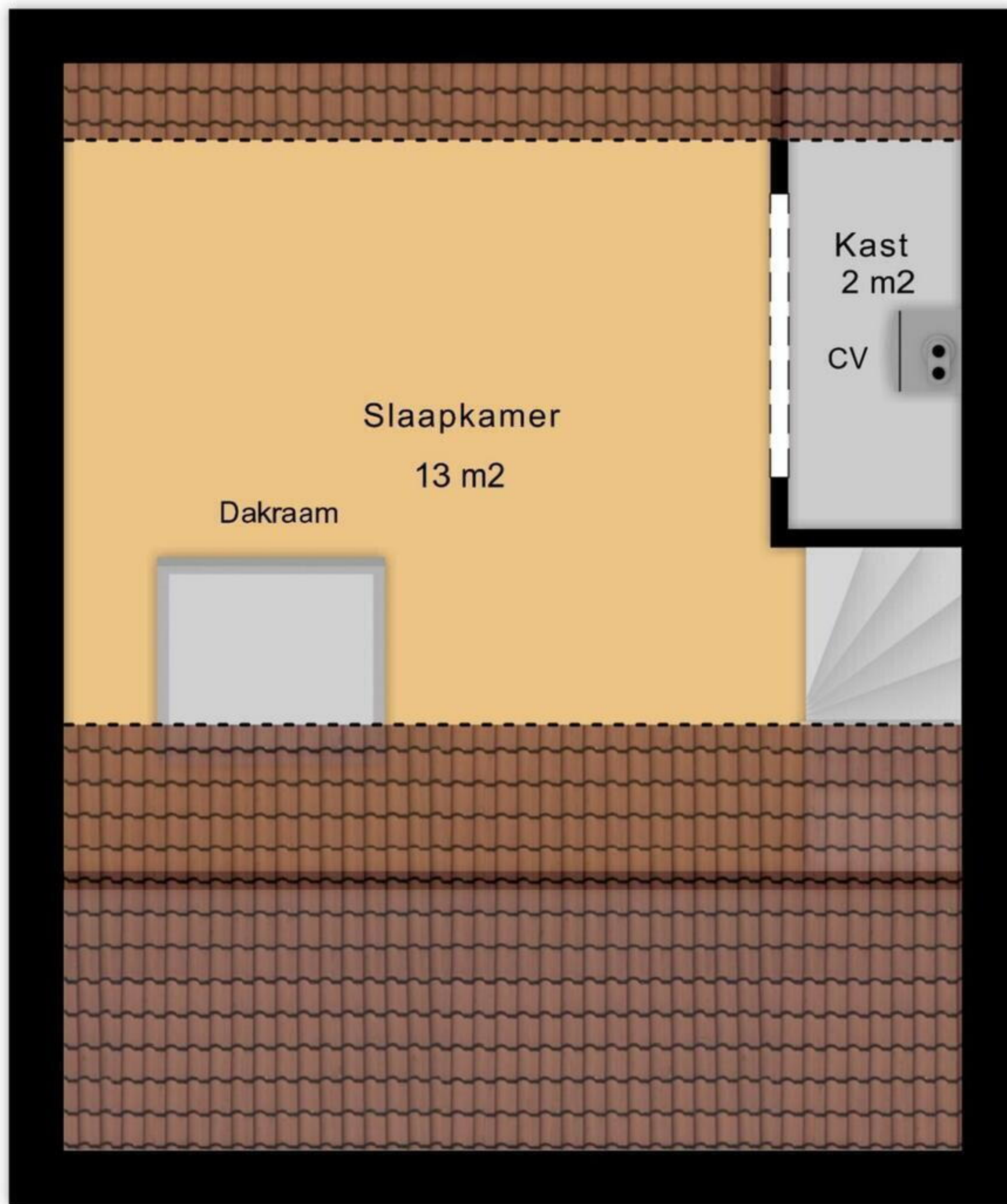

2.54 m  
1.77 m  
1.42 m

4.90 m

Zolder

← 1.74 m →



↑  
3.21 m  
↓

**Berging**