

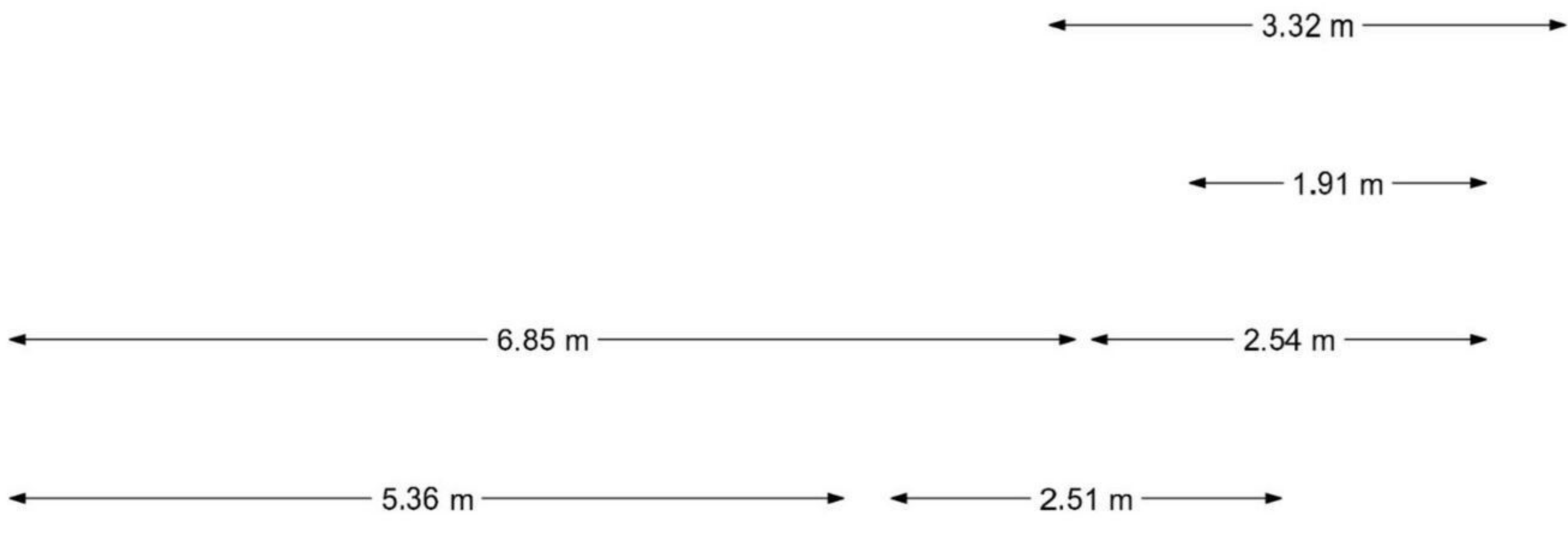

Begane Grond



Eerste Verdieping

7.42 m

3.72 m

3.65 m

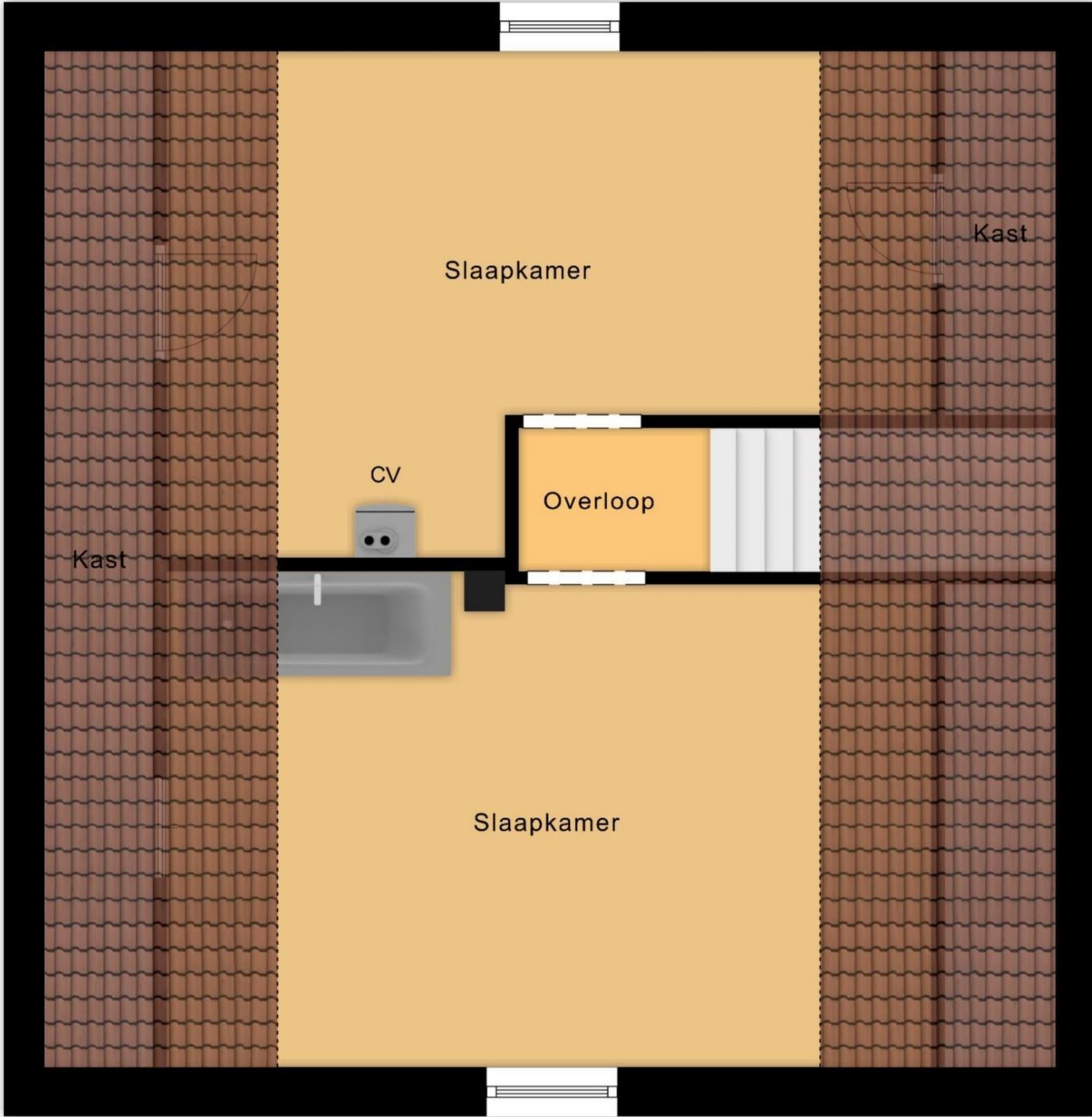

2.67 m

1.05 m

3.55 m

7.47 m

0.80 m

5.62 m

0.81 m

3.99 m

Tweede Verdieping

← 2.99 m →



↑
4.91 m
↓

Overkapping

← 1.99 m →

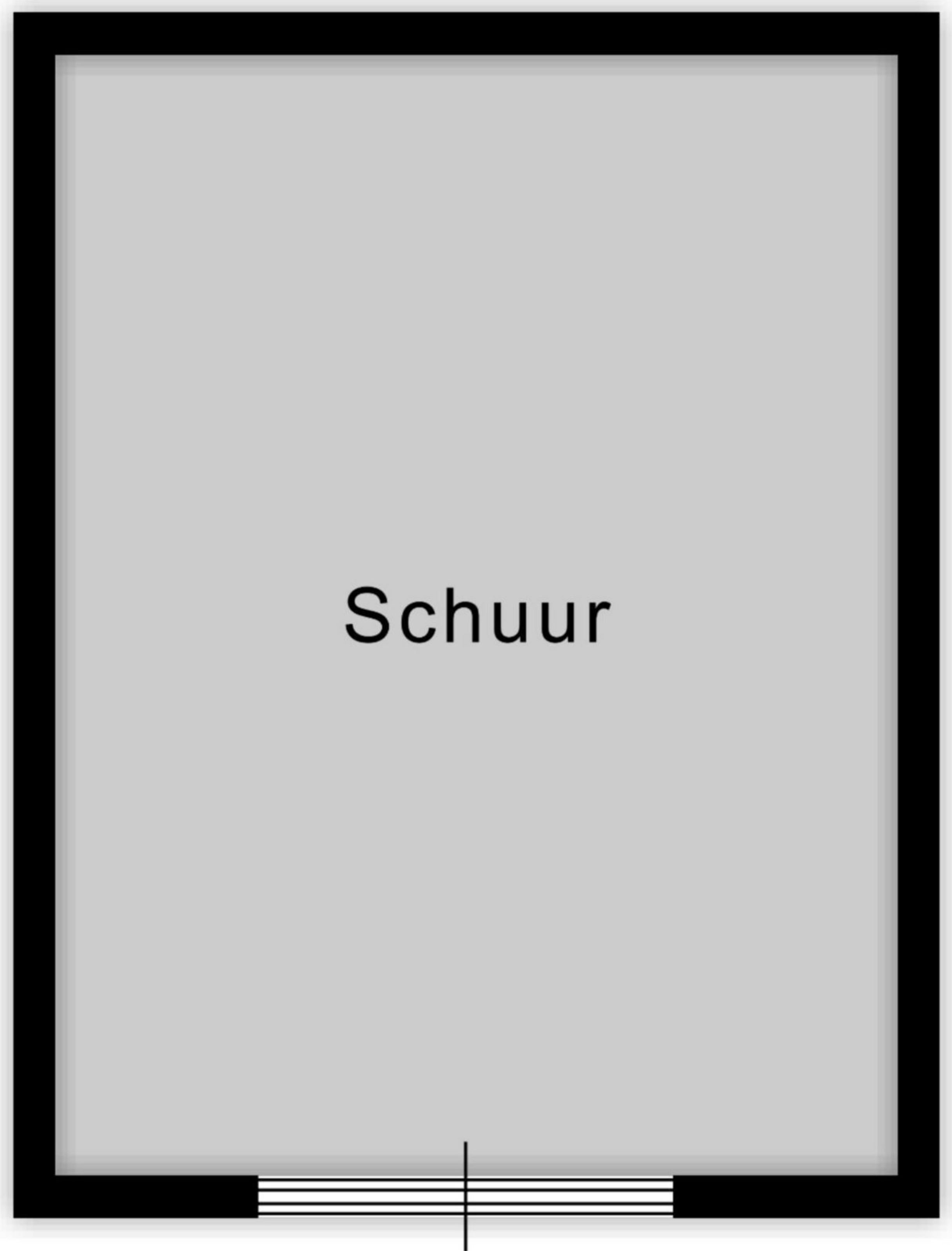

Schuur

↑
2.65 m
↓

Schuur