



Begane Grond

← 2.61 m → ← 1.73 m →  
← 1.70 m → ← 0.82 m →

↑ 2.99 m ↓  
↑ 0.90 m ↓  
↑ 3.11 m ↓



↑ 2.16 m ↓  
↑ 2.69 m ↓  
↑ 5.10 m ↓  
↑ 2.31 m ↓

← 3.44 m → ← 0.90 m →

Eerste Verdieping

1.91 m

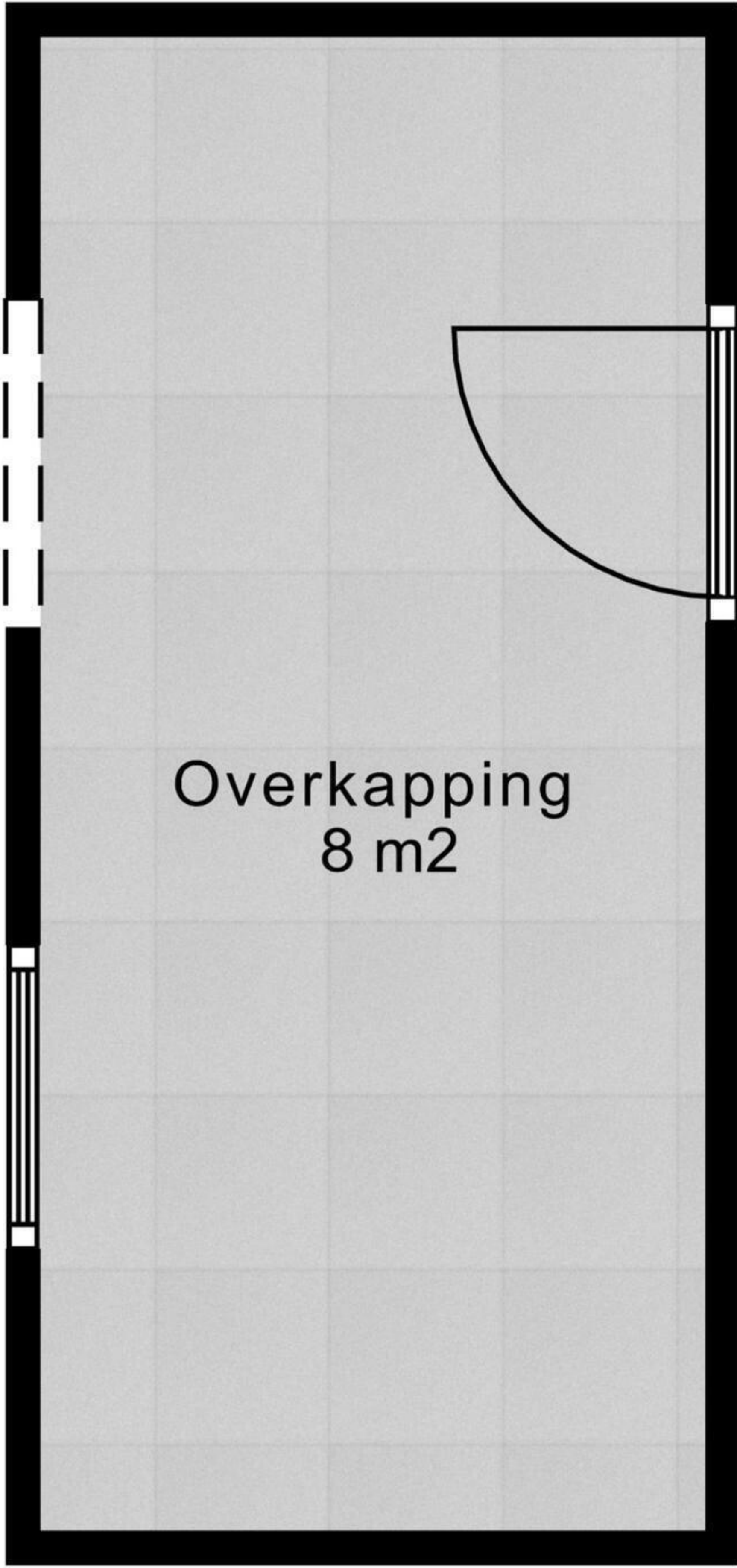

4.28 m

Overkapping