



Begane Grond

7.40 m

6.95 m

3.63 m

3.18 m

2.11 m

6.40 m

3.12 m

4.75 m

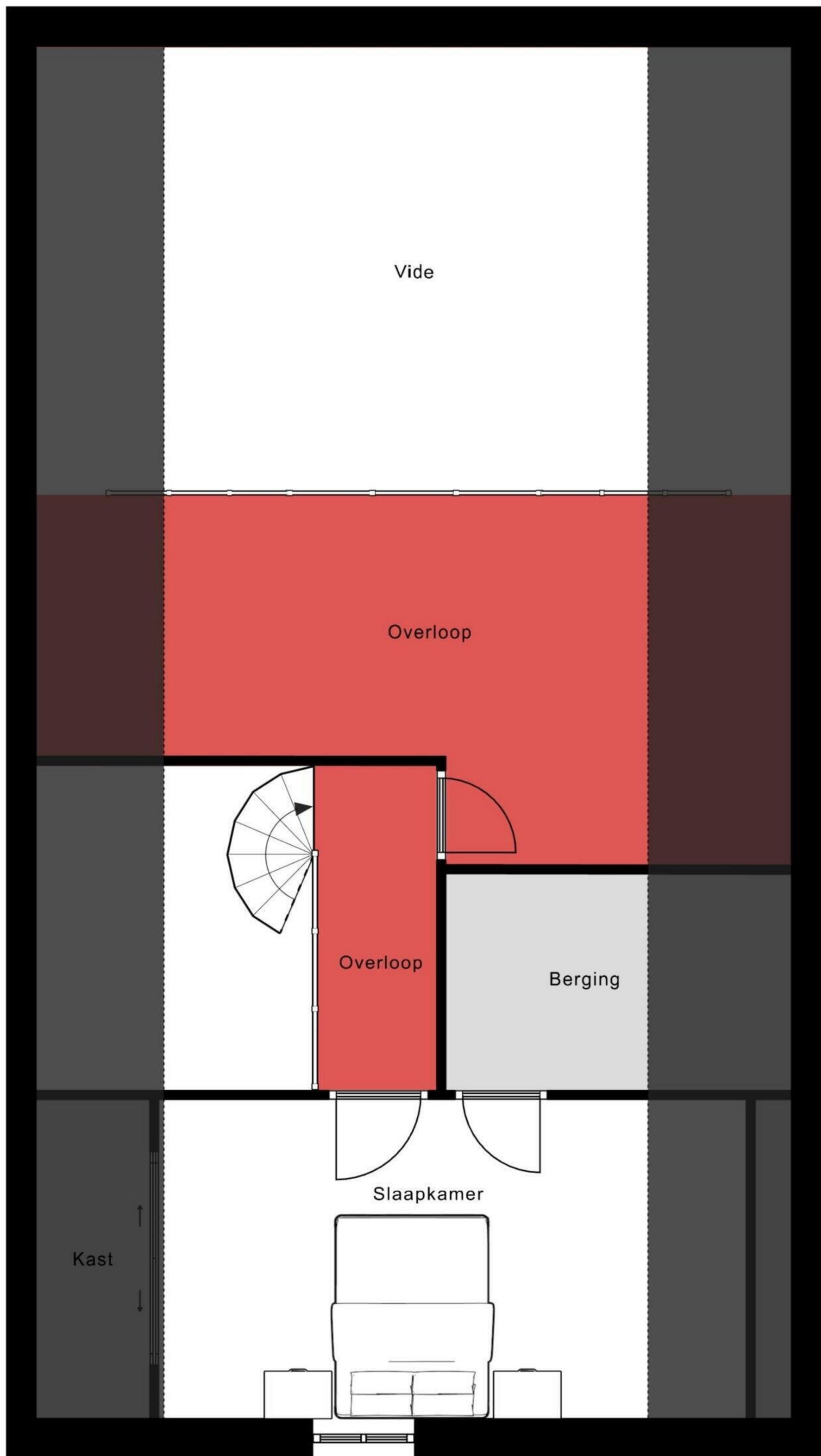

Eerste Verdieping

3.95 m

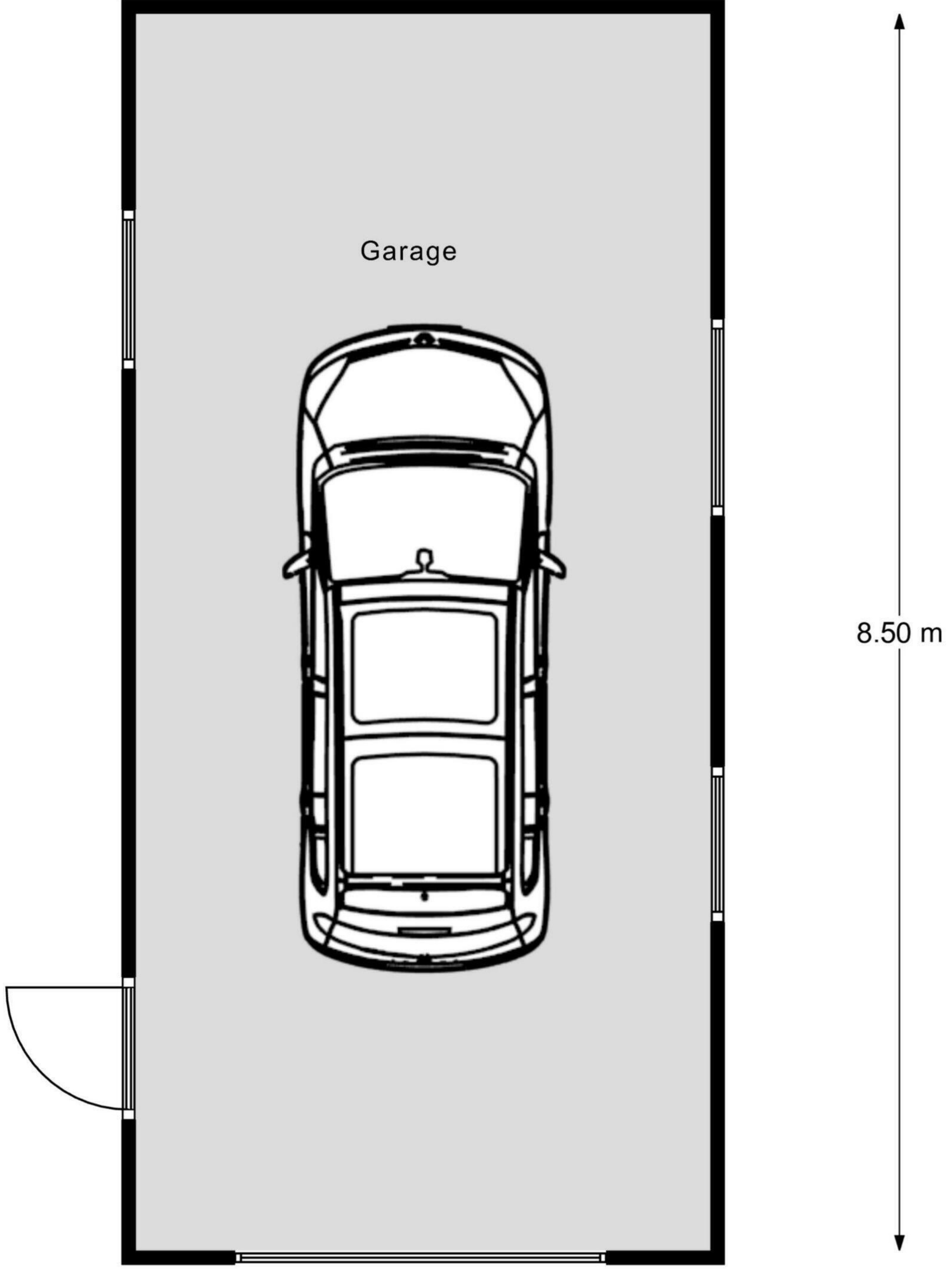

Garage

8.50 m

Garage Begane Grond

← 3.95 m →

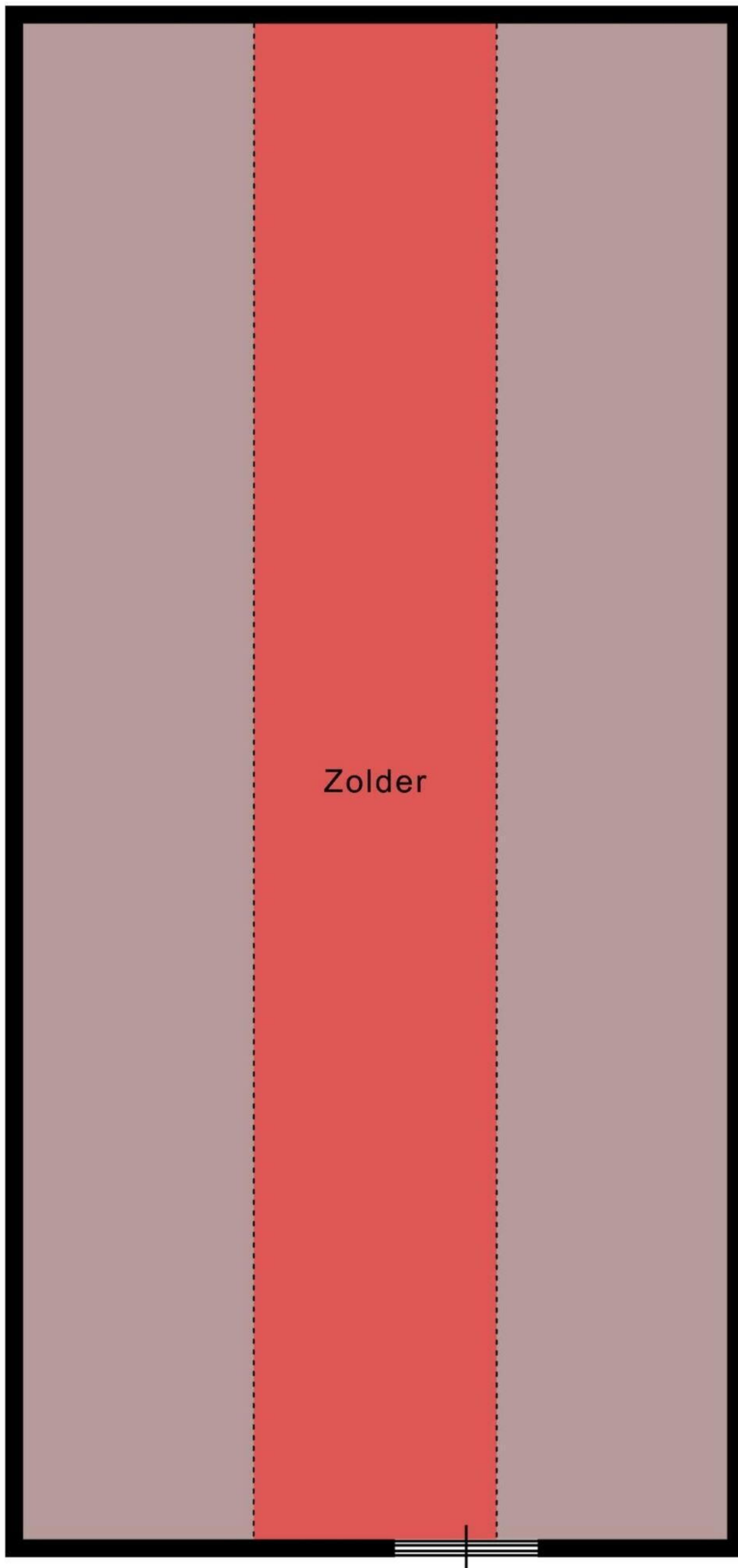

Zolder

8.50 m

← 1.36 m →

Garage Zolder

12.06 m

6.18 m

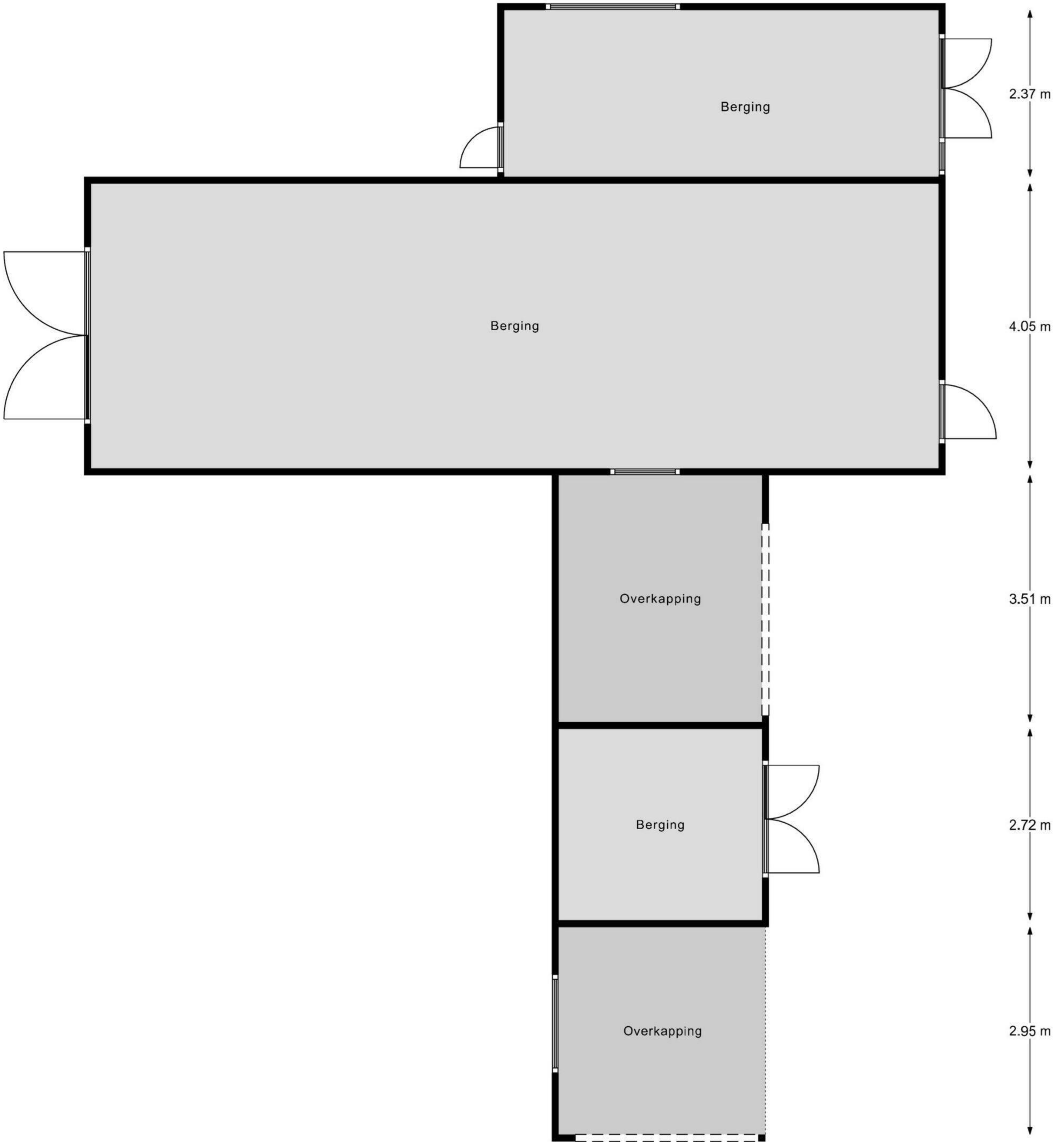

2.37 m

4.05 m

3.51 m

2.72 m

2.95 m

2.94 m

Berging

