

PATIO  
 $10.2 \times 4.5$

AANBOUW  
 $7.3 \times 2.7$

EETKAMER  
 $4.5 \times 3.5$

KEUKEN  
 $2.9 \times 3.2$

WOONKAMER  
 $4.5 \times 4.5$

HALL

BERGING

CARPORT  
 $2.9 \times 3.8$

BEGANE GROND

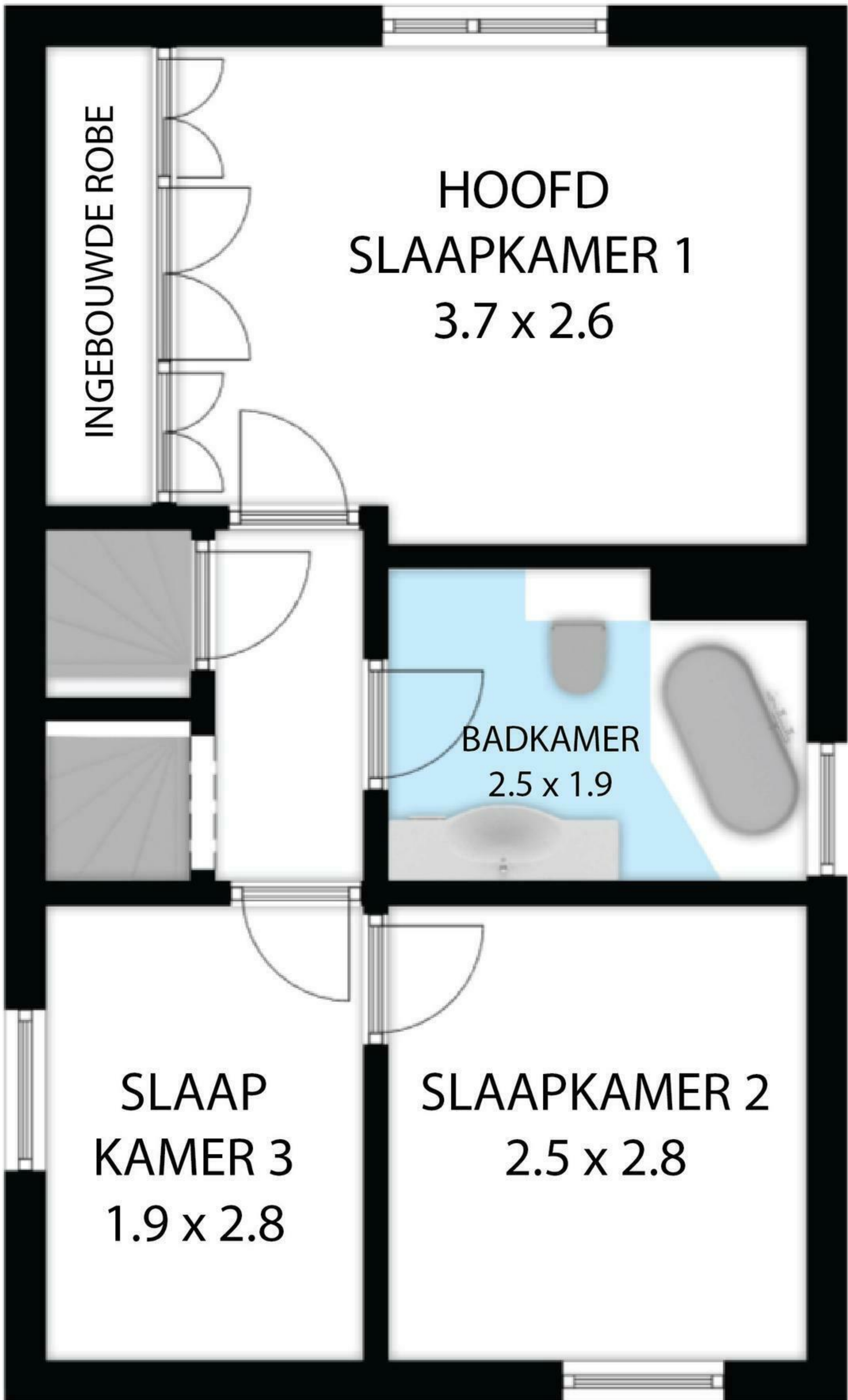

# EERSTE VERDIEPING

4DE SLAAPKAMER  
4.4 x 6.2

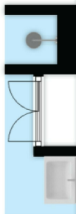

ZOLDER

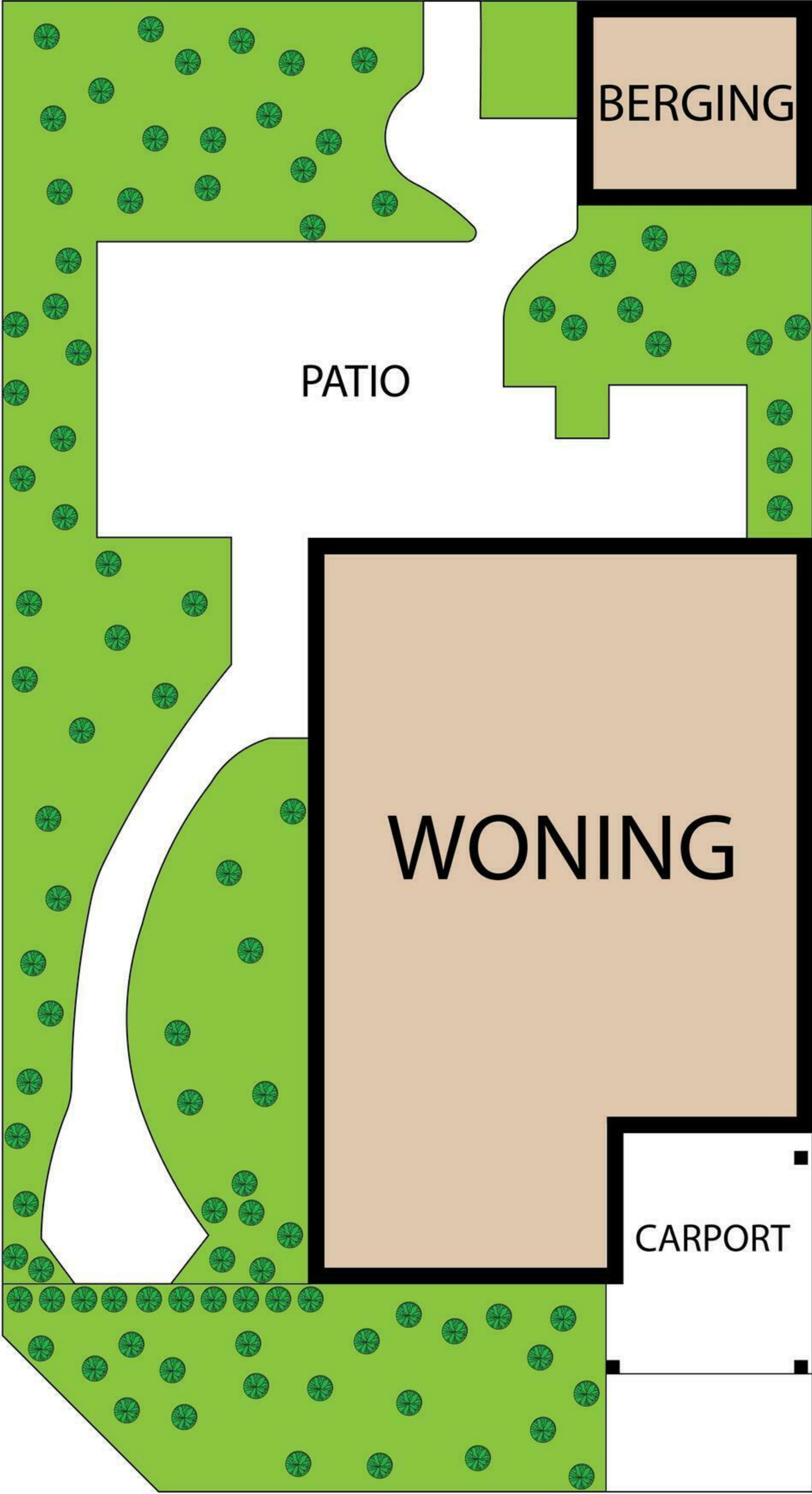

BERGING

PATIO

WONING

CARPORT

