



Begane Grond

4.00 m

1.69 m

2.31 m 1.03 m

0.52 m 2.63 m 1.27 m

7.10 m
2.86 m
2.02 m
1.31 m
3.57 m

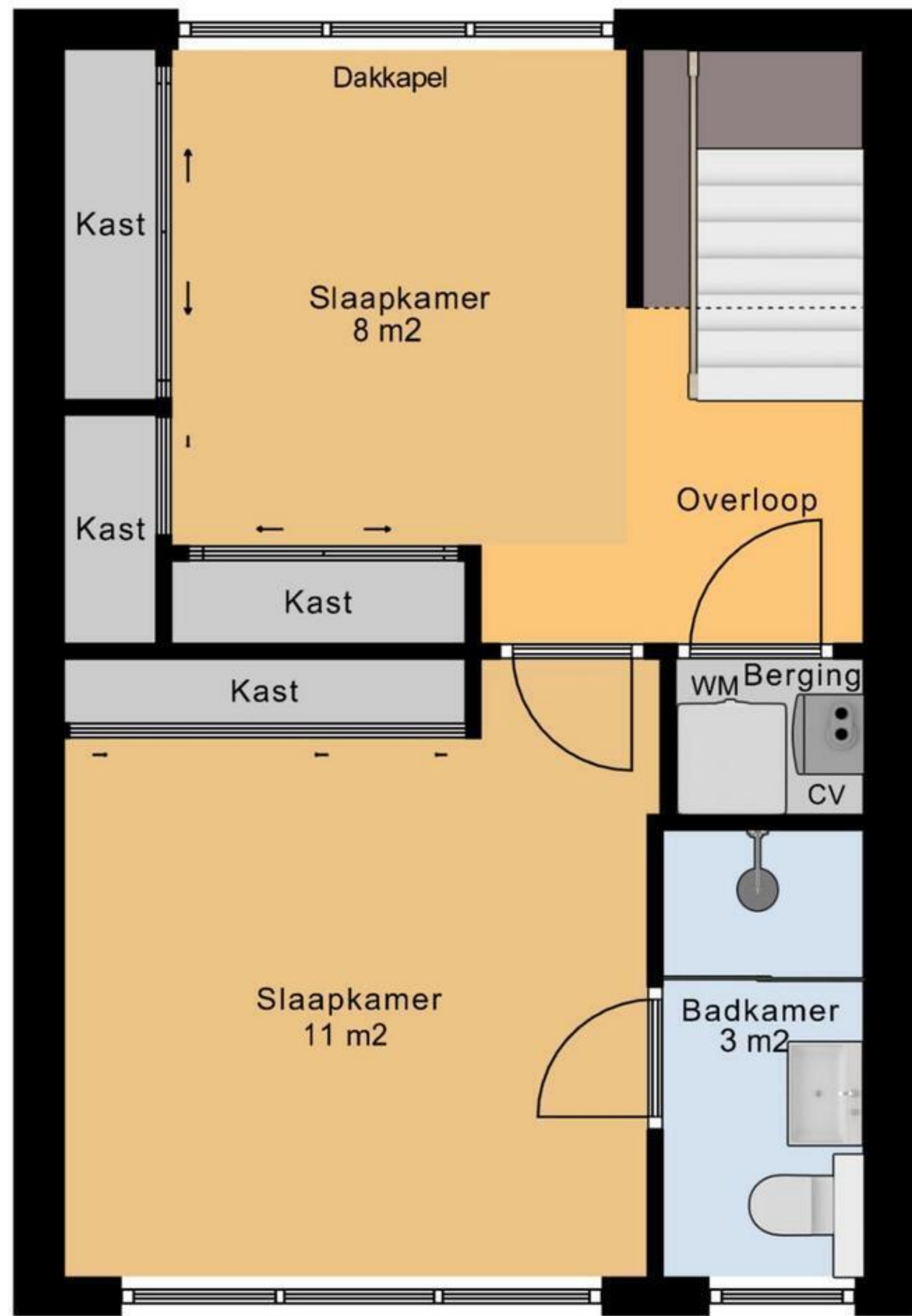

3.43 m
1.94 m
0.89 m
2.58 m

3.37 m 1.08 m

3.44 m 1.08 m

4.62 m

Eerste Verdieping

← 2.27 m →

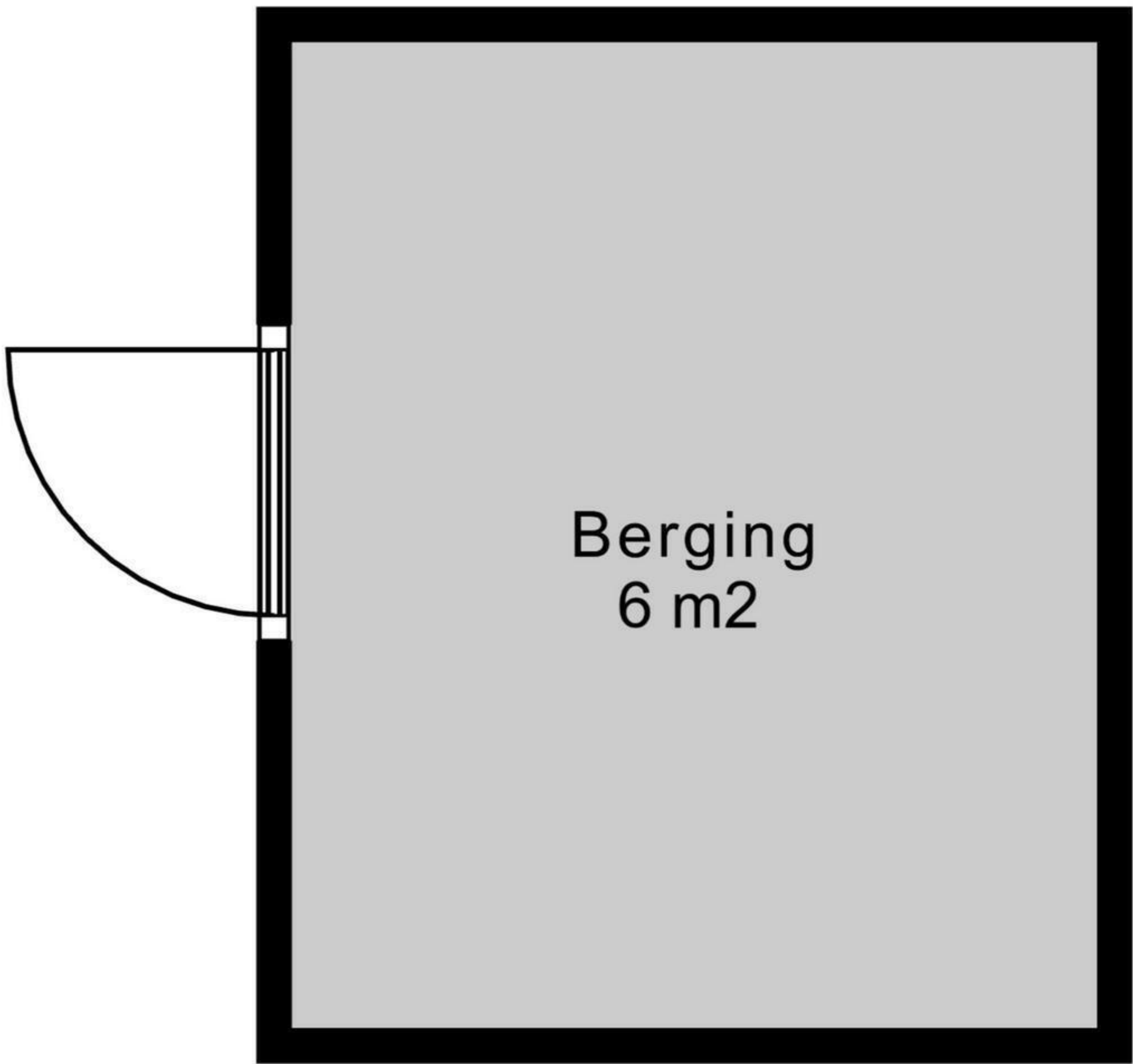

↑
2.78 m
↓

Berging 1

← 2.19 m →

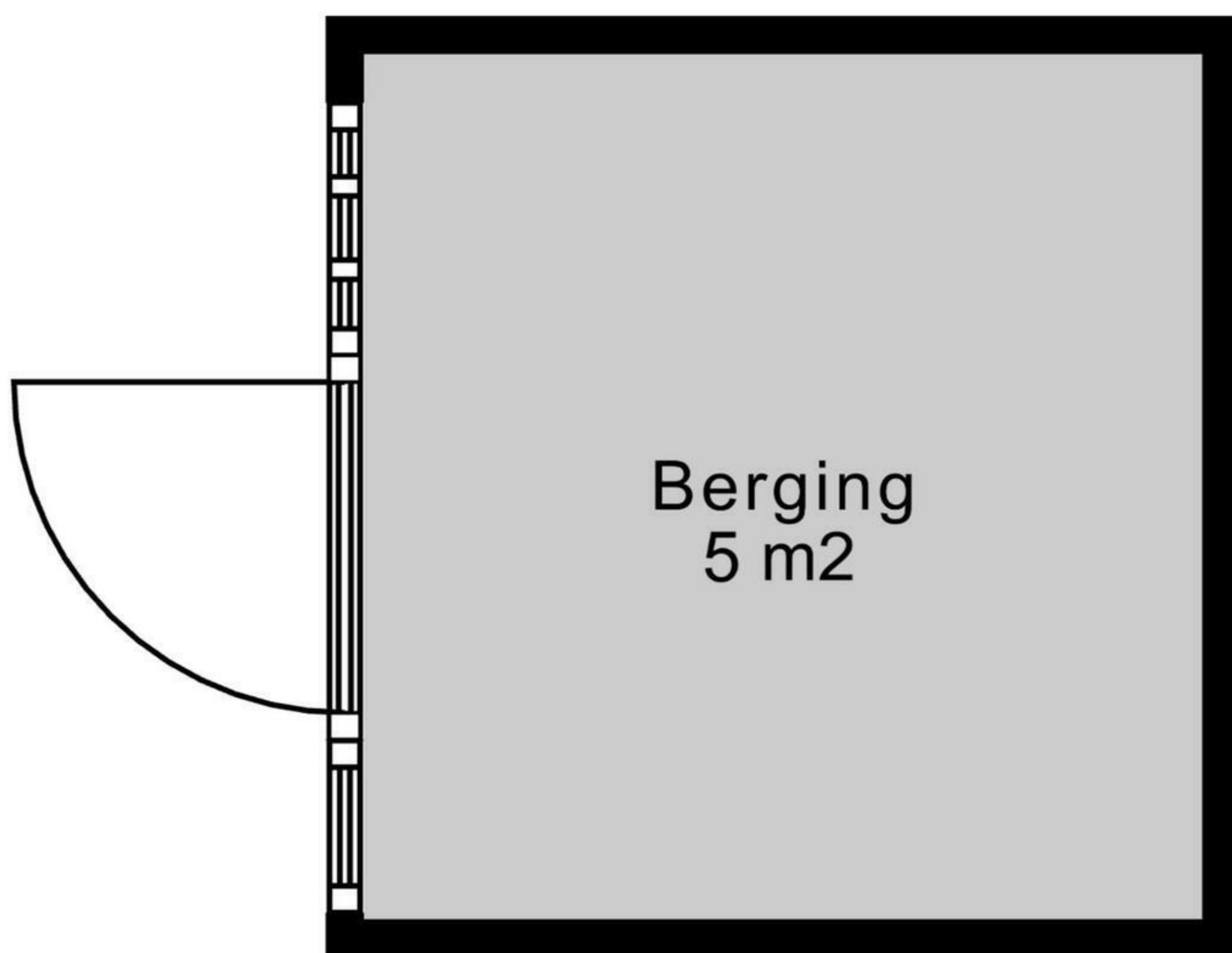

↑
2.26 m
↓

Berging 2