

← 4.76 m →

← 1.62 m →

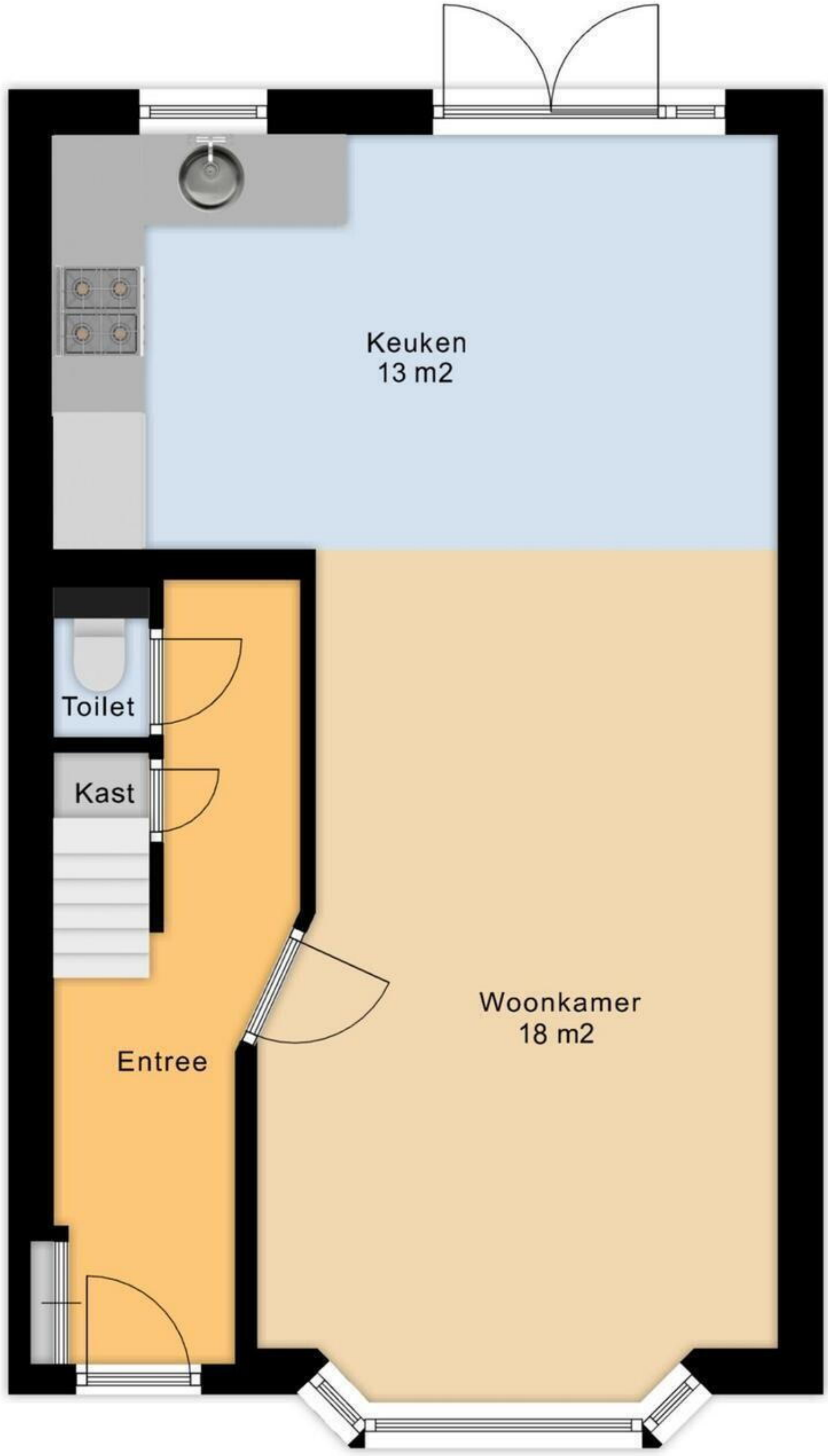

↑ 2.73 m

↑ 7.98 m

↓

5.25 m

↑ 0.98 m

↑ 3.11 m

↑ 0.81 m

↑ 5.11 m

0.63 m

← 2.47 m →

← 1.19 m →

Begane Grond



Eerste Verdieping

0.55 m ← 3.45 m →

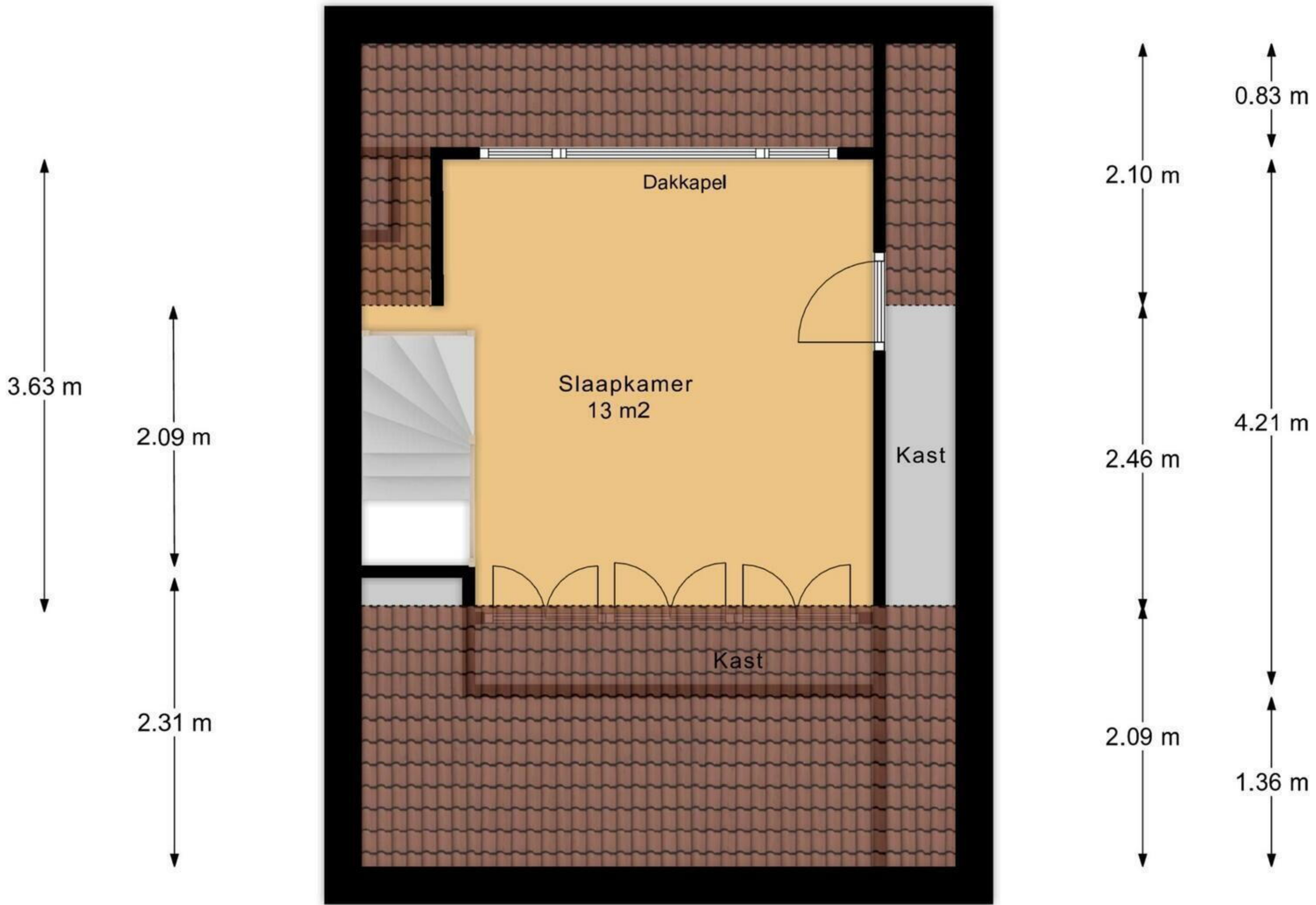

← 3.19 m → 0.56 m

← 4.10 m →

Zolder

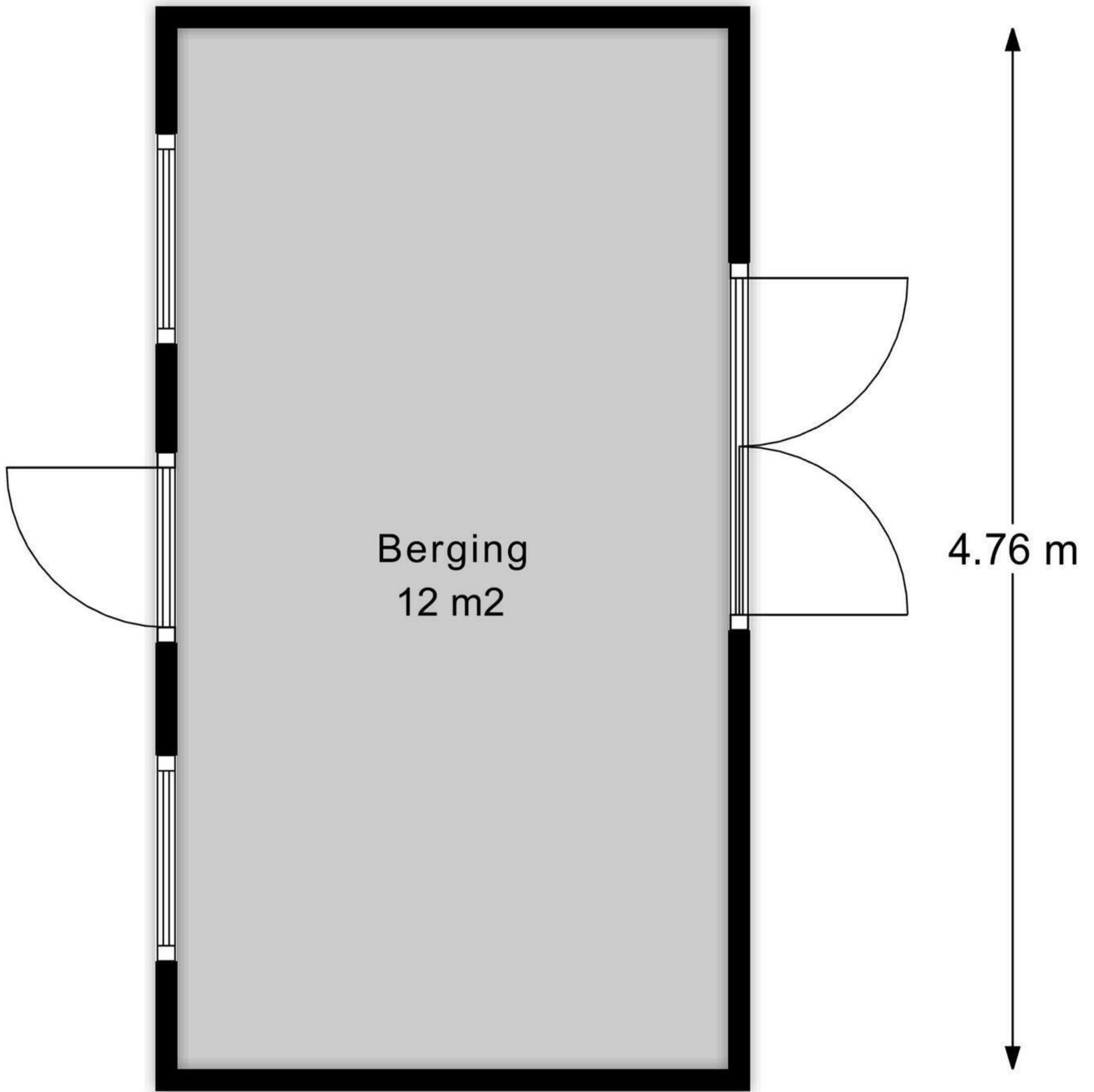

Berging