

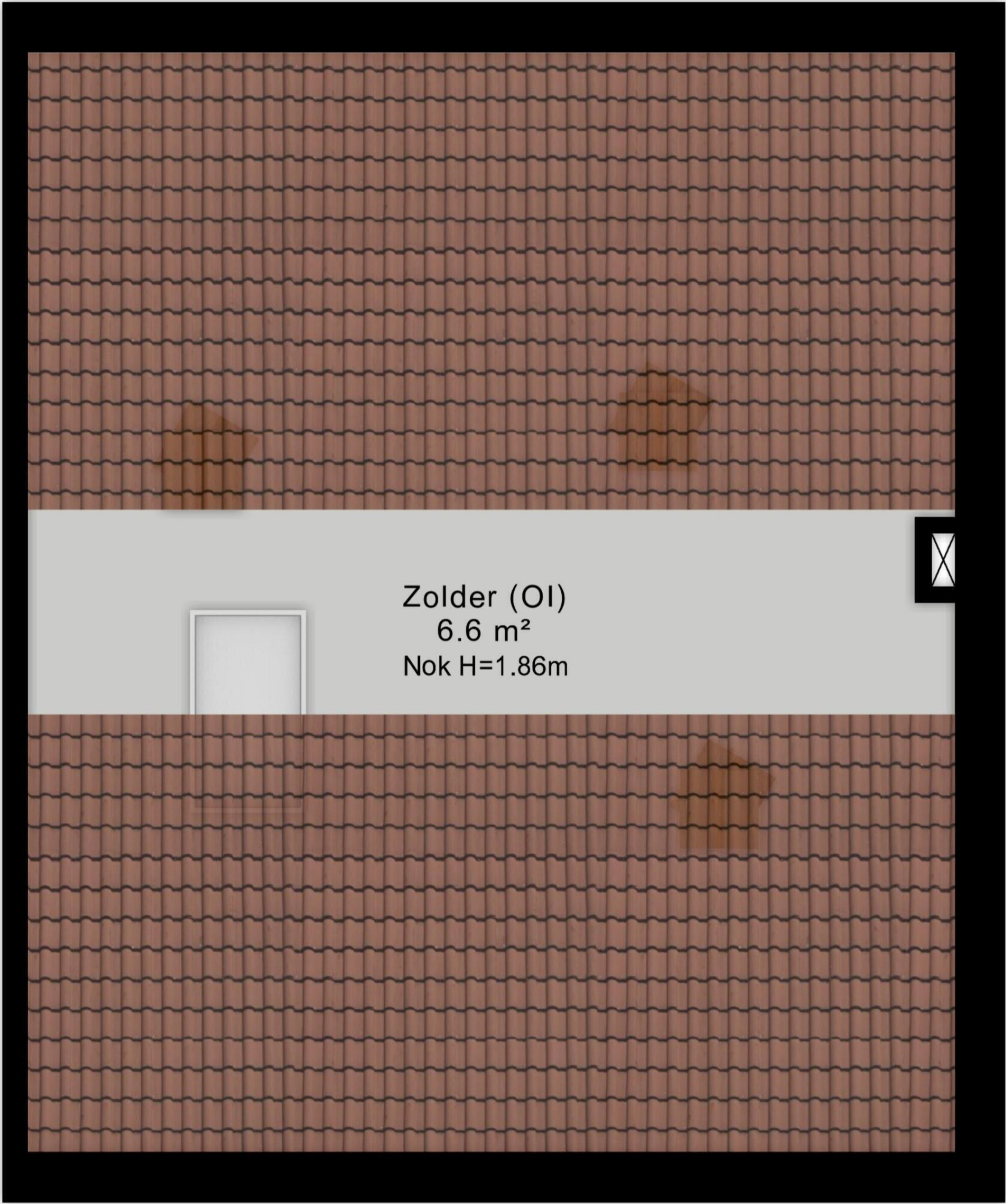

← 5.50 m →



↑ 6.52 m ↓

← 5.50 m →



← 1.90 m →

↑  
2.32 m  
↓

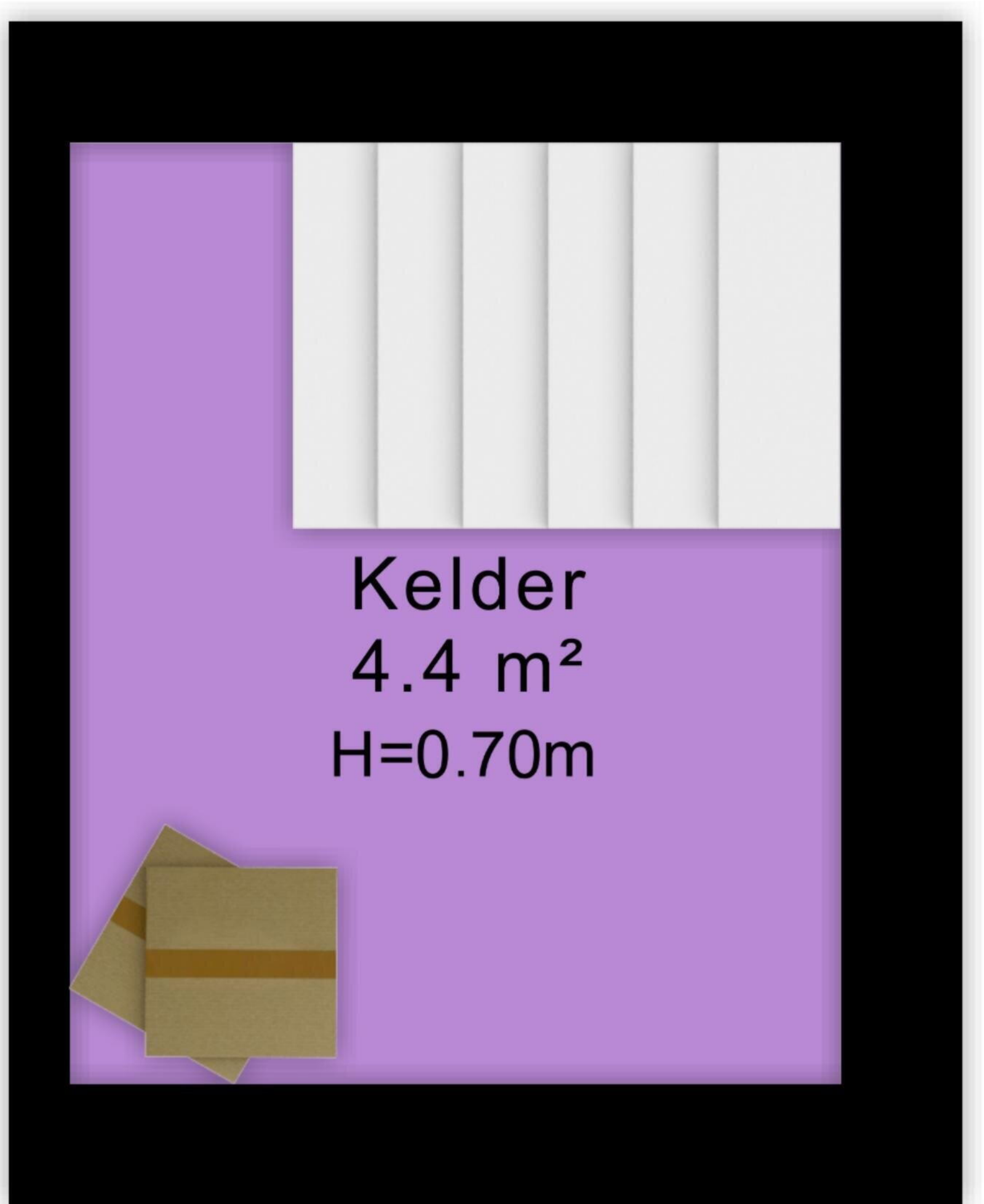

← 2.24 m →

Berging (EB)  
6.8 m<sup>2</sup>  
Nok H=3.00m

↑  
3.02 m  
↓

← 2.26 m → ← 3.02 m → ← 4.63 m →

4.03 m

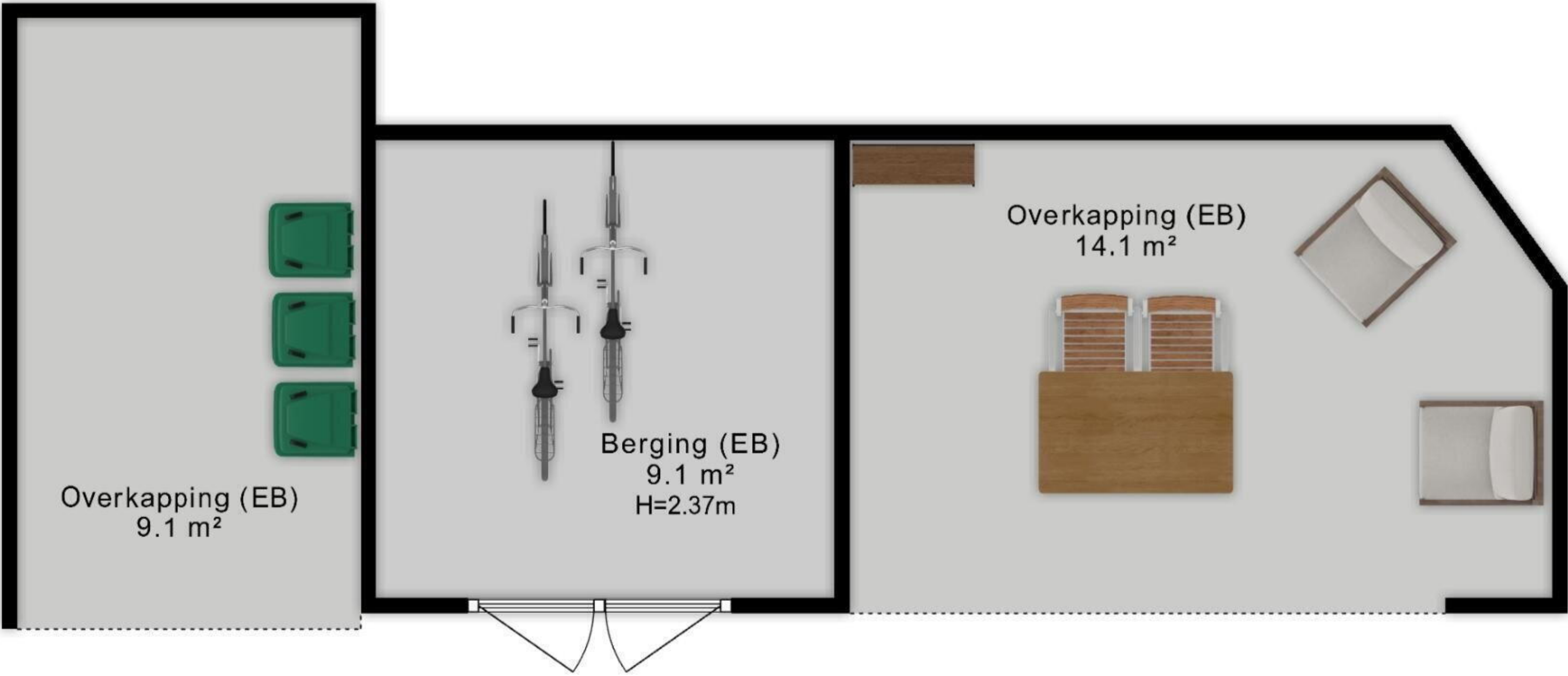

3.02 m