

**STUDIO  
(NIET IN POSITIE)**

SLAAPKAMER  
2.28 x 4.56 m

GANG  
2.28 x 3.19 m

GANG  
1.74 x 3.19 m

GANG  
3.60 x 4.56 m

SLAAPKAMER  
3.67 x 3.44 m

GANG  
2.53 x 3.15 m

SLAAPKAMER  
3.67 x 3.86 m

SLAAPKAMER  
3.09 x 5.75 m

BADKAMER  
1.52 x 2.55 m

SPEELGEBIED  
2.38 x 2.85 m

SPEELGEBIED  
4.58 x 3.97 m

WINKEL  
2.64 x 1.88 m

WASSERIJ  
2.64 x 1.87 m

OPSLAG  
9.35 x 2.85 m

WINKEL  
2.30 x 3.18 m

GARAGE  
4.50 x 4.89 m

**EERSTE VERDIEPING**

**KELDER**

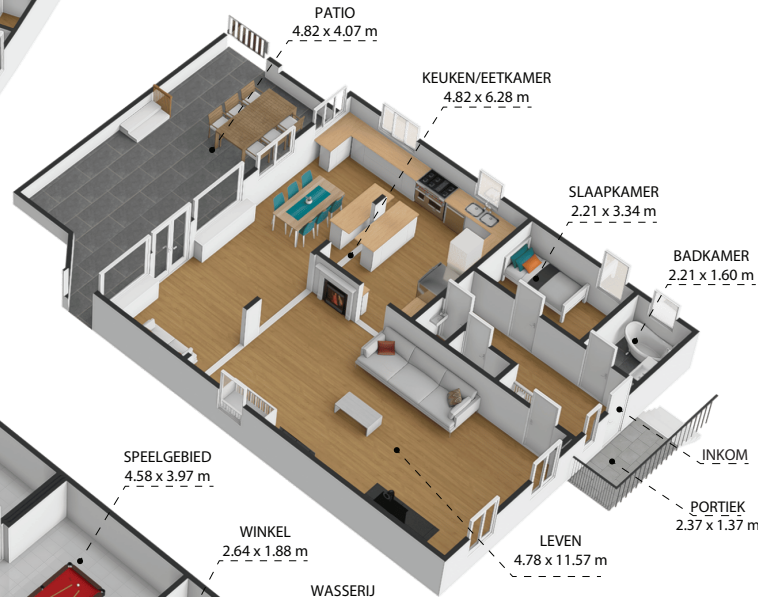

**BEGANE GROND**

PATIO  
4.82 x 4.07 m

KEUKEN/EETKAMER  
4.82 x 6.28 m

SLAAPKAMER  
2.21 x 3.34 m

BADKAMER  
2.21 x 1.60 m

INKOM

PORTIEK  
2.37 x 1.37 m

LEVEN  
4.78 x 11.57 m



STUDIO

RESIDENTIE

PORTIEK

PATIO

RUE DE BEUSDAEL 23, 4851, PLOMBIÈRES, RÉGION WALLONNE, 4851

TOTAL APPROX. FLOOR AREA 329 SQ.M

Whilst every attempt has been made to ensure the accuracy of the floor plan contained here, measurements of doors, windows, rooms and any other items are approximate and no responsibility is taken for any error, omission, or misstatement. This plan is for illustrative purposes only and should be used as such by any prospective purchaser.